

# Loadpin

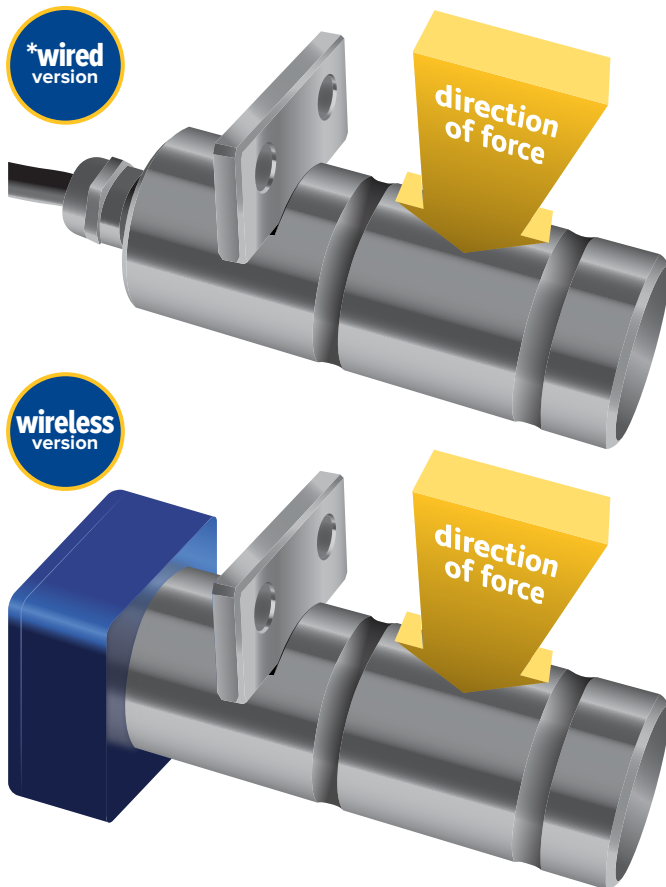

## Applications:

- Marine tankers, offshore platforms
- Elevator and floor conveyor testing and certification
- Bearing blocks, pivots and shackles
- Cable laying equipment
- Rope, chain, and brake anchors
- Bridge support cables
- Mooring lines
- Pulleys and sheaves
- Crane cables
- Hoisting gear
- Winches
- Design validated by F.E.A.

**Please note:** Please advise cable configuration on order - Radial or Axial pin exit.

If you require a Loadpin to a particular size and design, download Straightpoint's Loadpin questionnaire and return, POA. [www.straightpoint.com/loadpin.html](http://www.straightpoint.com/loadpin.html)



\*Requires connection to Straightpoint's Handheld plus (HHP), Desktop Controller data logging software (DCP10M) or External Amplifier range (SA-3420) that can be configured to provide outputs such as 4-20mA, 0-10v, 0-5v for PLC or data logger integration.

**The Straightpoint range of Load Measurement Pins (LMP's) are designed for use in applications where an end of line load cell cannot be used an integrated solution is required.**

Often a customised solution they are manufactured from high tensile stainless steel and are normally supplied complete with an anti-rotation plate as a cabled or wireless solution.

Built to withstand the harshest environments in industries such as marine and offshore oil and gas they are suitable for use in exposed situations and can be supplied to withstand immersion in seawater to extreme depths.

Straightpoint Loadpins are typically connected to Straightpoint's Handheld plus or may be supplied with a vast array of output formats to include mV/V, RS-422, RS-485, utilising the ASCII, MODBUS TRU and CAN-BUS protocols or an analogue output such as 4-20mA for PLC integration. They are also supplied with a 10 metre / 32ft cable as standard however usable cable length varies greatly with lengths available to 1500 metres / 4900ft depending on output format.

Please email your enquiry to: [sales@straightpoint.com](mailto:sales@straightpoint.com)

Also available with hazardous area approval. Zones 0, 1 & 2



**ATEX / IECEx**  
Ex ia II C T4 Ga

Certification numbers:

**LP ATEX**

IECEx SIR 16.0041X / Sira 16ATEX2108X

**SW-HHP ATEX**

IECEx SIR 15.0072X / Sira 15ATEX2196X

**Add 'ATEX' to the part number  
when ordering ATEX/IECEx products.  
For example: LP500KG-ATEX**

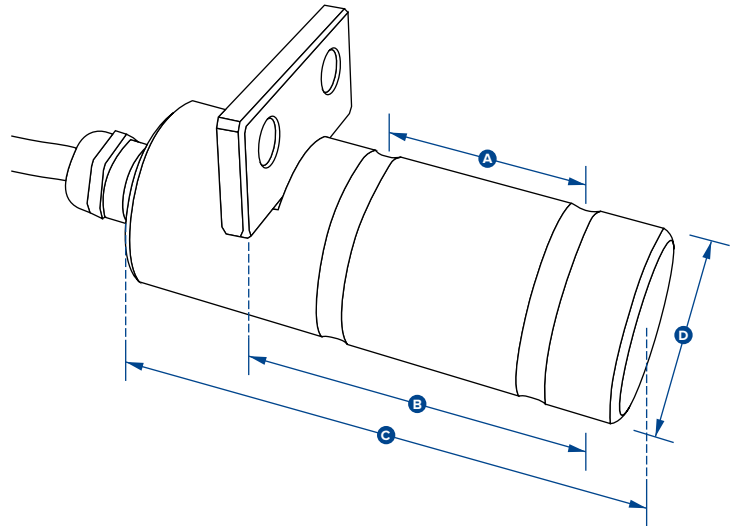

| Part Number    | LP500KG  | LP1T             | LP2.5T          | LP3.5T          | LP6.5T           | LP15T           | LP25T           | LP50T            | LP100T            | LP250T            | LP500T             | LP750T             | LP1000T             | LP1500T             |
|----------------|--|------------------|-----------------|-----------------|------------------|-----------------|-----------------|------------------|-------------------|-------------------|--------------------|--------------------|---------------------|---------------------|
| Capacity       | 500kg<br>1100lb  | 1000kg<br>2200lb | 2.5te<br>5500lb | 3.5te<br>7700lb | 6.5te<br>14000lb | 15te<br>33000lb | 25te<br>55000lb | 50te<br>110000lb | 100te<br>220000lb | 250te<br>550000lb | 500te<br>1100000lb | 750te<br>1650000lb | 1000te<br>2200000lb | 1500te<br>3300000lb |
| Resolution     | 0.2kg<br>0.5lb   | 0.5kg<br>1lb     | 0.001te<br>2lb  | 0.001te<br>2lb  | 0.002te<br>5lb   | 0.002te<br>5lb  | 0.005te<br>10lb | 0.01te<br>20lb   | 0.05te<br>100lb   | 0.1te<br>200lb    | 0.2te<br>500lb     | 0.2te<br>500lb     | 0.5te<br>1000lb     | 0.5te<br>1000lb     |
| Units          | kgs, tonnes<br>lbs   |                  |                 |                 |                  |                 |                 |                  |                   |                   |                    |                    |                     |                     |
| Weight         | 0.9kg<br>0.4lb   | 1kg<br>0.5lb     | 1.2kg<br>0.9lb  | 1.4kg<br>1.3lb  | 2kg<br>2.6lb     | 3.1kg<br>5lb    | 5.6kg<br>10.3lb | 8.6kg<br>18lb    | 11.8kg<br>24lb    | 29.8kg<br>64lb    | 79.2kg<br>172lb    | 146kg<br>319lb     | 275kg<br>603lb      | 389kg<br>854lb      |
| Safety Factor  | 300% of SWL  |                  |                 |                 |                  |                 |                 |                  |                   |                   |                    |                    |                     |                     |
| Operating Temp | -20°C to +70°C / -4°F to 158°F   |                  |                 |                 |                  |                 |                 |                  |                   |                   |                    |                    |                     |                     |
| Accuracy       | ±1% of full scale  |                  |                 |                 |                  |                 |                 |                  |                   |                   |                    |                    |                     |                     |
| Protection     | IP67 (IP68 available as an option) / NEMA 6 (NEMA 6P available on application) |                  |                 |                 |                  |                 |                 |                  |                   |                   |                    |                    |                     |                     |
| Dimension A    | 24<br>0.94"  | 35<br>1.38"      | 45<br>1.77"     | 50<br>1.97"     | 63<br>2.48"      | 75<br>2.95"     | 89<br>3.50"     | 102<br>4.02"     | 110<br>4.33"      | 130<br>5.12"      | 225<br>8.86"       | 295<br>11.61"      | 360<br>14.17"       | 430<br>16.93"       |
| Dimension B    | 36<br>1.42"  | 49<br>1.93"      | 70<br>2.76"     | 75<br>2.95"     | 95<br>3.74"      | 114<br>4.49"    | 152<br>5.98"    | 178<br>7.01"     | 190<br>7.48"      | 220<br>8.66"      | 370<br>14.57"      | 500<br>19.69"      | 612<br>24.09"       | 731<br>28.78"       |
| Dimension C    | 70<br>2.76"  | 80<br>3.15"      | 100<br>3.94"    | 105<br>4.13"    | 125<br>4.92"     | 150<br>5.91"    | 195<br>7.68"    | 225<br>8.86"     | 230<br>9.06"      | 300<br>11.81"     | 440<br>17.32"      | 590<br>23.23"      | 712<br>28.03"       | 832<br>32.76"       |
| Dimension ØD   | 20<br>0.79"  | 20<br>0.79"      | 25<br>0.98"     | 30<br>1.18"     | 40<br>1.57"      | 50<br>1.97"     | 63<br>2.48"     | 75<br>2.95"      | 88<br>3.46"       | 125<br>4.92"      | 170<br>6.69"       | 200<br>7.87"       | 250<br>9.84"        | 275<br>10.83"       |